

# DATA SHEET: IDZ20M300

Kroepelin GmbH  
Gartenstraße 50  
36381 Schlüchtern

Telefon (06661)86 0  
Telefax (06661)86 39  
sales@kroepelin.com  
www.kroepelin.com

**Kroepelin**  
Längenmesstechnik

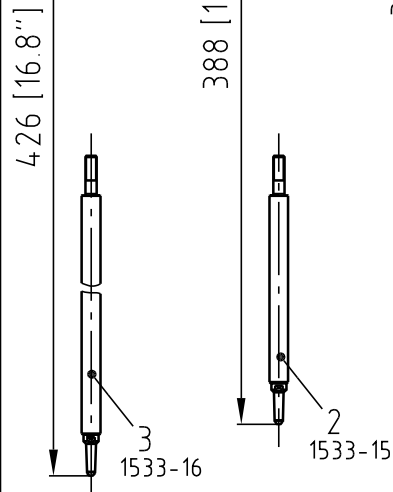
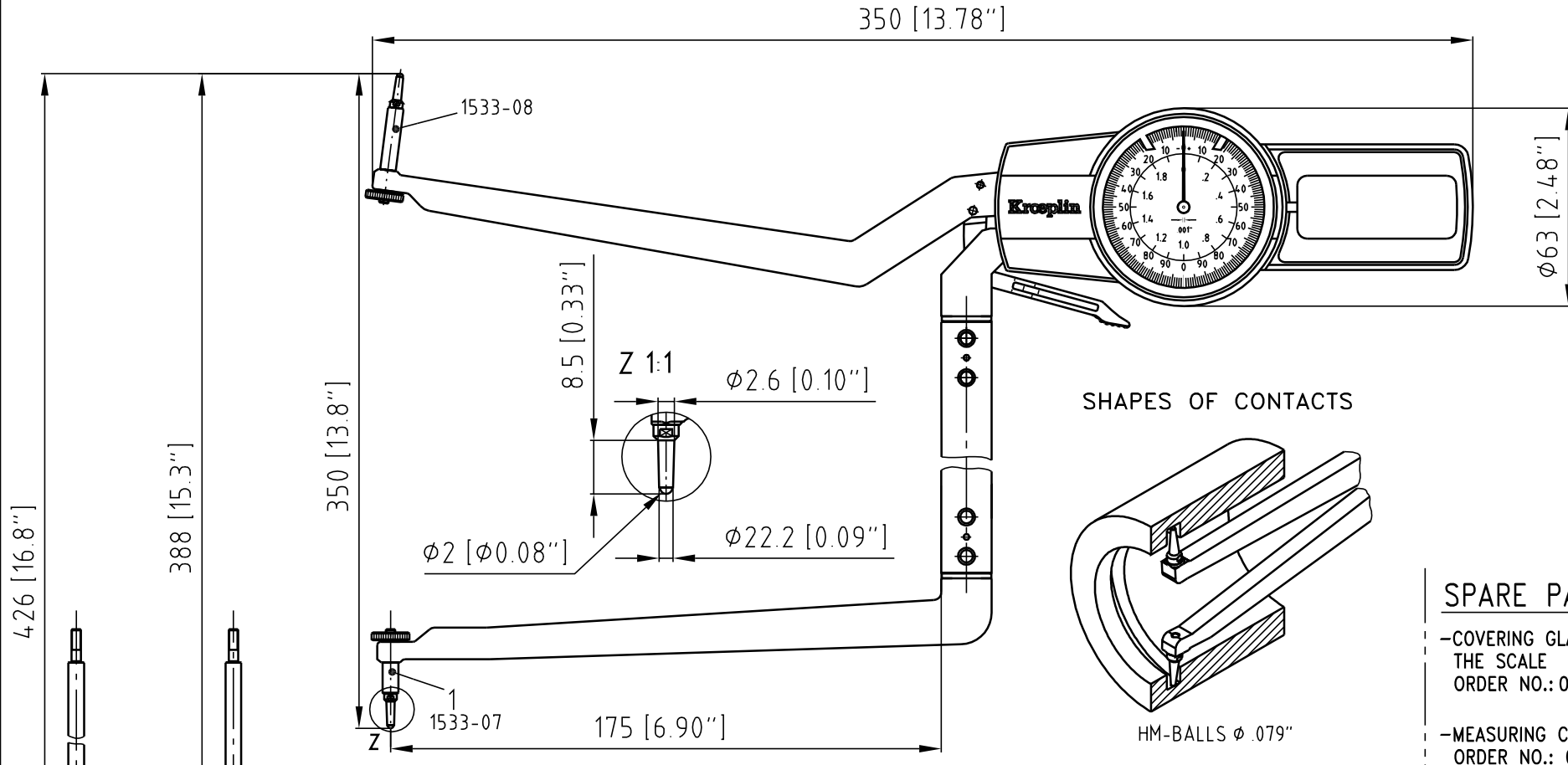

### SHAPES OF CONTACTS

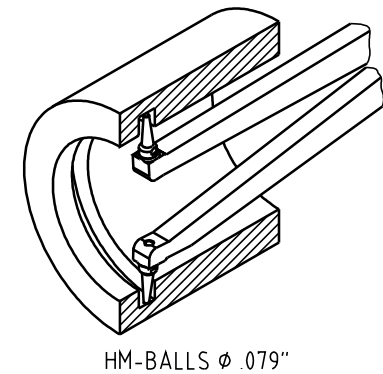

### SPARE PARTS

- COVERING GLASS OF THE SCALE  
ORDER NO.: 0450-08
- MEASURING CONTACT  
ORDER NO.: 0251-02
- HANDLE  
ORDER NO.: 0450-13

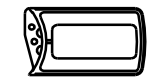

*)	Range of application with measuring contact 1	11.8" - 13.8"
	Range of application with measuring contact 2	13.3" - 15.3"
	Range of application with measuring contact 3	14.8" - 16.8"

\*\*) GAUGE FOR COMPARISON MEASUREMENT

SUBJECT TO TECHNICAL ALTERATIONS

SCALE 1:2

TYPE: Intertest	PRICECLASS: 30	MEASURING FORCE: 1.2 -2N	ACCEPTABLE DEVIATIONS (VDI/VDE/DGQ 2618 Bl. 12.1/13.1)	REFERENCE TEMPERATURE: 20°C
RANGE OF APPLICATION: 11.8"-16.8" *)	WEIGHT: 600g	REPEATABILITY r = .002"	MAX. PERMISSIBLE ERRORS G = .006"	OPERATION TEMPERATURE: 10°C - 30°C
SCALE INTERVAL: .001"				STORAGE TEMPERATURE: -10°C - 50°C